

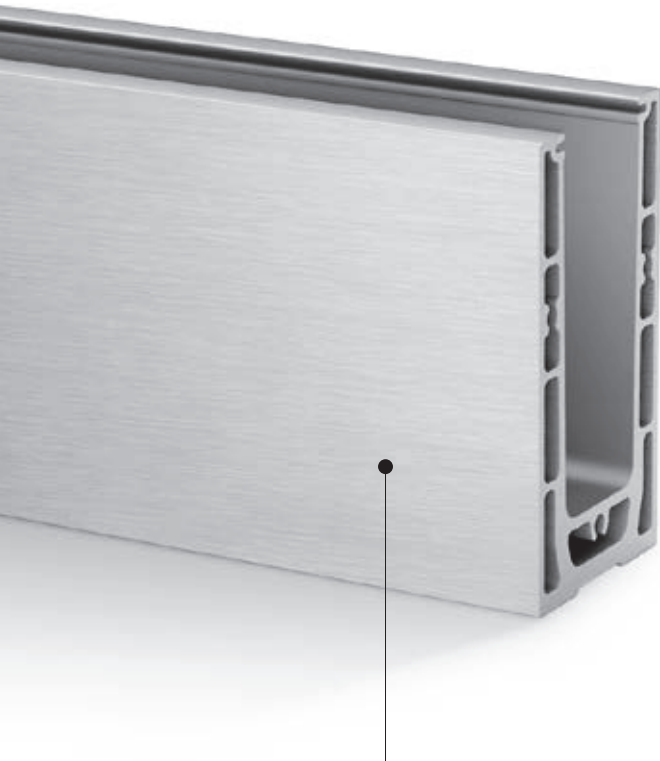

EASY GLASS[®] SMART

ALIGN YOUR MEDIUM-SIZED
PROJECTS IN NO TIME



Ease of installation for glass thicknesses of 1/2" – 1 1/16"

With the adjustable Q-disc® System for glass mounting and alignment, Smart lets you complete glass fixing, alignment or removal quickly and intuitively. In fact, these jobs can be finished faster than ever before. What an easy way to save time and money!

- Light and medium use for indoor or outdoor railings
- Symmetrical top-mount base shoe
- Minimal use of anchors
- Choice of fixing methods
- Optional aluminum shoe shims available for leveling uneven surfaces
- Can be combined with:
 - All Q-railing glass-mounted handrails, cap rails, U-profiles and edge protection
 - Q-lights Linear Light for LED-lit handrails and cap rails

Incorporates the adjustable Q-disc System. Turn to page 16 to find out all about this groundbreaking approach for aligning and securing glass.



EASY GLASS® SMART VARIANTS

Smart Top mount

- Also for in-floor mounting (protective layer needs to be applied)
- Optional base shoe cladding

Smart Fascia mount

- Suitable for parapet walls
- Optional base shoe cladding

Smart Fascia mount

- Optional base shoe cladding
- Also allows inverse-mounting
- For parapet walls

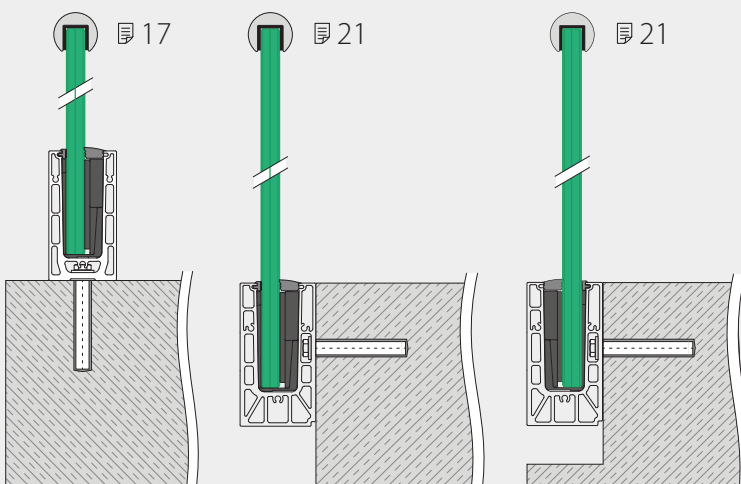

***Only available on demand.**
Does your project qualify for one of these custom base shoes, then please contact us to discuss the options.

Smart F* Top mount

- Can be mounted at or beyond the edge of a surface

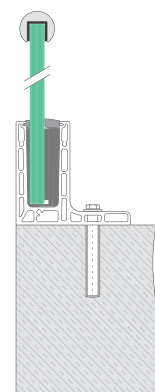

Smart Y* Fascia mount

- Can be mounted at or beyond the edge of a surface

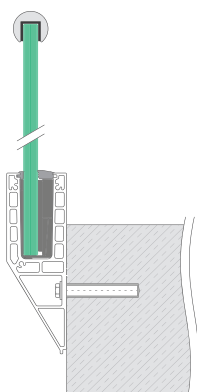



ADJUSTABLE Q-DISC® SYSTEM

SLIDE AND ALIGN!



HOW IT WORKS:

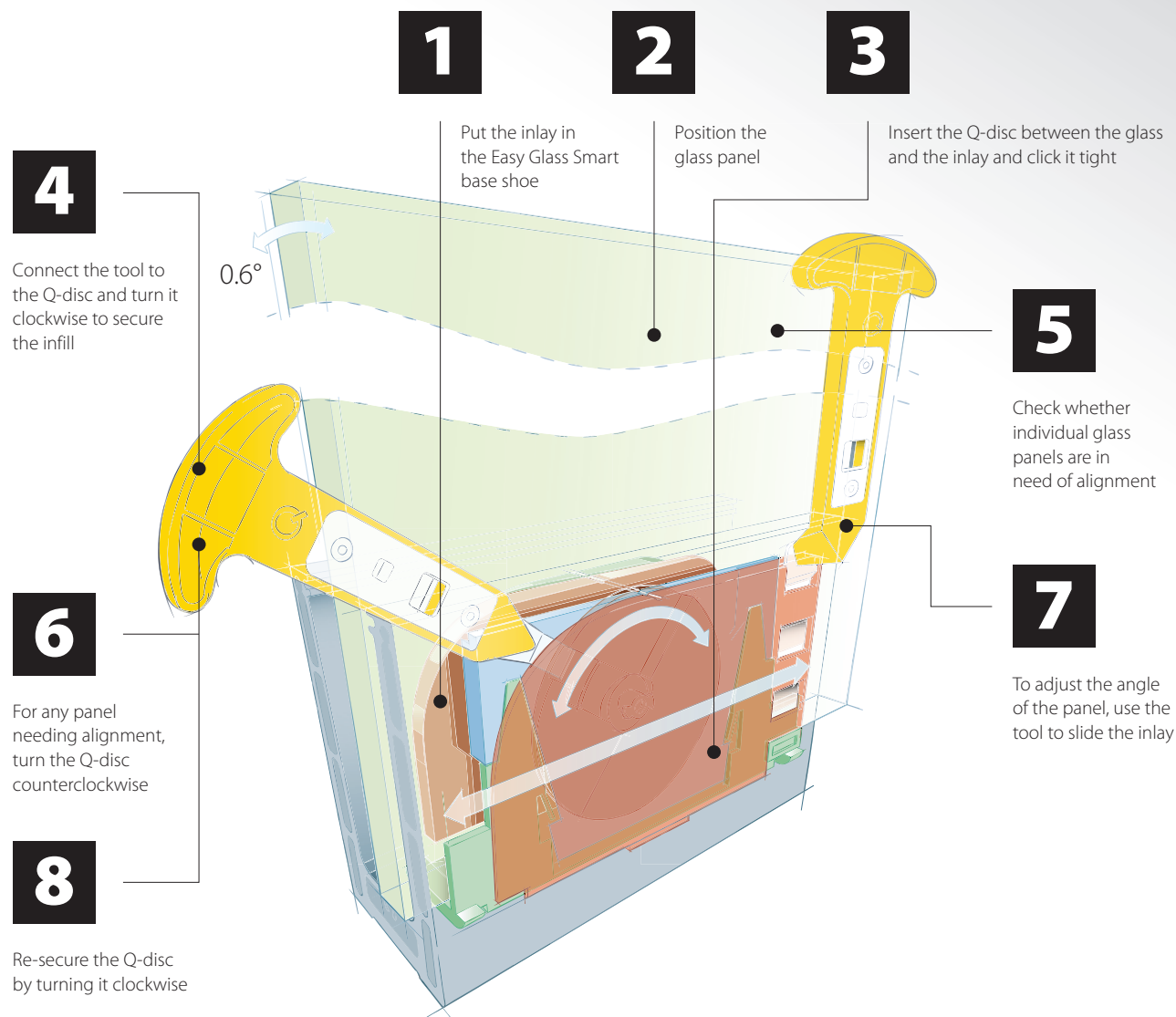

EASY GLASS® SMART - Base shoe, top mount

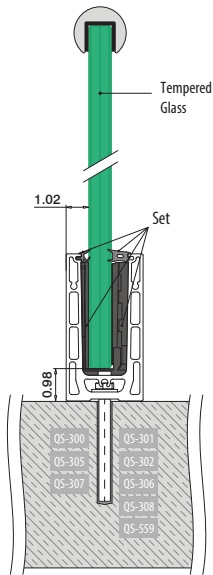

Please refer to the respective certificates for specifications such as mounting details, glass dimensions and glass type (laminated glass / monolithic glass).



Assembly information:
q-railing.com/
qr-smart

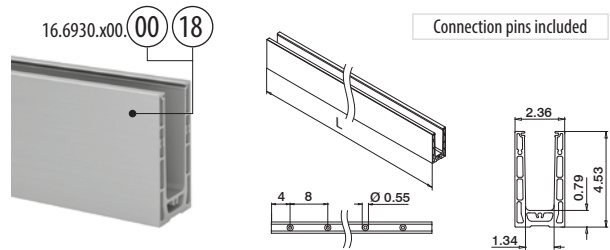

MOD 6930

Aluminum	Mill finish	
16.6930.600.00	See overview on 226	L = 20' (6096 mm)
Aluminum	Brushed, anodized	
OUTDOOR		
16.6930.300.18	See overview on 226	L = 10' (3048 mm)
16.6930.600.18	See overview on 226	L = 20' (6096 mm)



Railing bases

EASY GLASS® SMART - Connectors, top mount

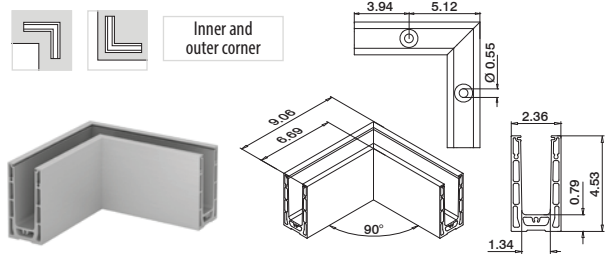

MOD 6313

Aluminum	Mill finish	
16.6313.030.00	See overview on 226	1
Aluminum	Brushed, anodized	
OUTDOOR		
16.6313.030.18	See overview on 226	1



Railing bases

EASY GLASS® - Connection pin

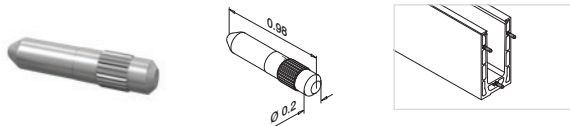

MOD 3005

316

OUTDOOR

14.3005.000.00

6



Q-INFO



Mill finish



Brushed, anodized

Q-INFO

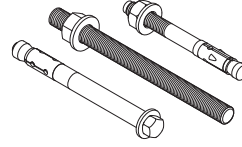

All anchors
See 226 – 233

Q-INFO

PREFIX

We can deliver the following service according to your specification:

- Cutting
- Bending
- Powder coating (aluminum mill finish products)

Contact us for details.

Railing bases

EASY GLASS® SMART -
Rubber set, inlay and Q-disc®

For adjustable
glass fixation

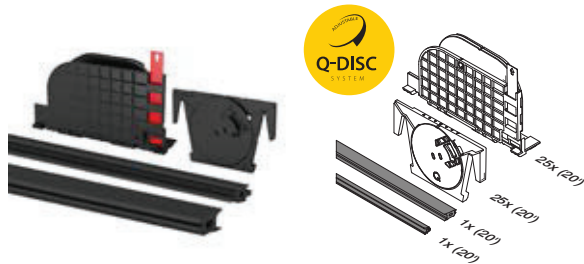

MOD 6931

Accessories

Monolithic	T (glass thickness)	
19.6931.612.00	1/2" (12 mm)	L = 20' (6096 mm)
19.6931.615.00	19/32" (15 mm)	L = 20' (6096 mm)
Laminated		
19.6931.613.00	1/2" (12.76 mm)	L = 20' (6096 mm)
19.6931.614.00	9/16" (13.52 mm)	L = 20' (6096 mm)
19.6931.617.00	5/8" (16.76 mm)	L = 20' (6096 mm)
19.6931.618.00	11/16" (17.52 mm)	L = 20' (6096 mm)

NEW

Q-disc System: Glass is securely retained. Drilling is not necessary.

Railing bases

EASY GLASS® SMART - Cover / intermediate rubber

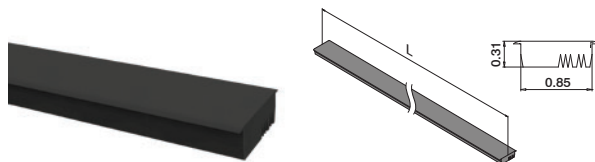

MOD 6901

Accessories

19.6901.001.00	L = 8.2' (2500 mm)
----------------	--------------------

NEW



Accessories

All dimension drawings are in inches

EASY GLASS® - Q-disc® and inlay tool



MOD 6922

Accessories

	Q	
19.6922.000.00	Q-84	1

NEW

Q-INFO MOD 6901

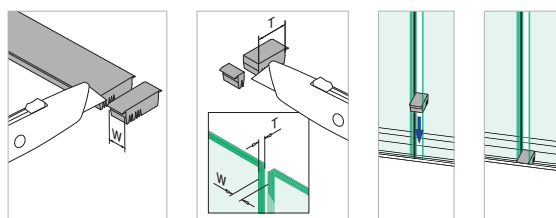

Q-INFO MOD 6922

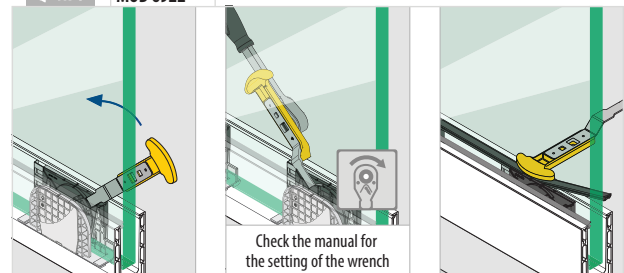

EASY GLASS® SMART - End fittings, top mount



Applicable left and right

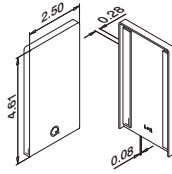

MOD 6734

Aluminum

Mill finish

16.6734.030.00

1

Aluminum

Brushed, anodized

OUTDOOR

16.6734.030.18

1

NEW

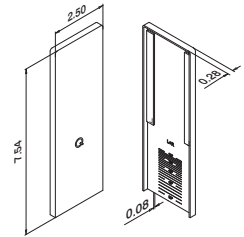
For stairs
Applicable left and right

MOD 6736

Aluminum

Mill finish

16.6736.030.00

1

Aluminum

Brushed, anodized

OUTDOOR

16.6736.030.18

1

NEW



EASY GLASS® SMART - End fitting for cladding



Applicable left and right

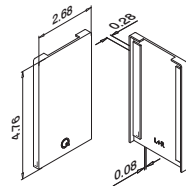

MOD 6734

Zinc

Stainless steel effect

OUTDOOR

10.6734.030.20

1

NEW

EASY GLASS® SMART - Cladding, top mount

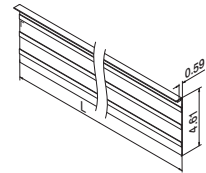

MOD 6920

316

OUTDOOR

14.6920.330.12

L = 10' (3048 mm)

NEW

Q-INFO

Zinc

MOD 10.6734

1



2

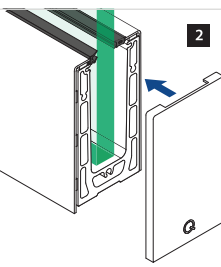

Q-INFO

MOD 6736

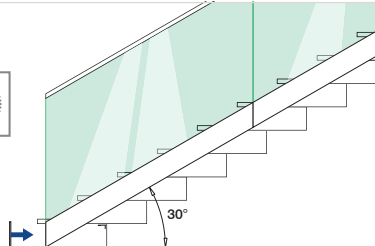
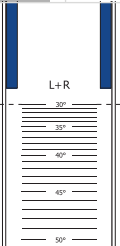

Q-INFO

MOD 6920

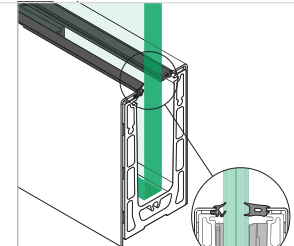
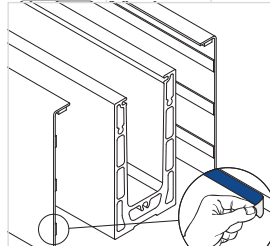

Railing bases

EASY GLASS® SMART - Shoe shims, top mount

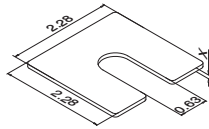

MOD 6921

Aluminum	Mill finish		
		X	
19.6921.160.00		0.04" (1 mm)	100
19.6921.260.00		0.08" (2 mm)	100
19.6921.360.00		0.12" (3 mm)	100

NEW

Railing bases

All dimension drawings are in inches

EASY GLASS® SMART - Drainage profile, top mount

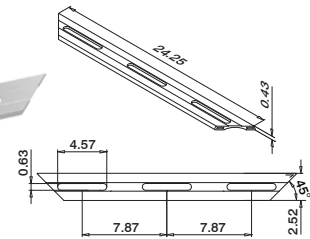
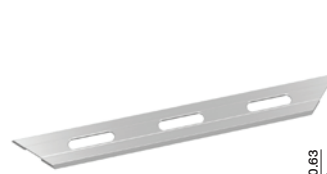

MOD 6948

Aluminum	Brushed, anodized		
16.6948.030.18		OUTDOOR	4

NEW

Q-INFO MOD 6921

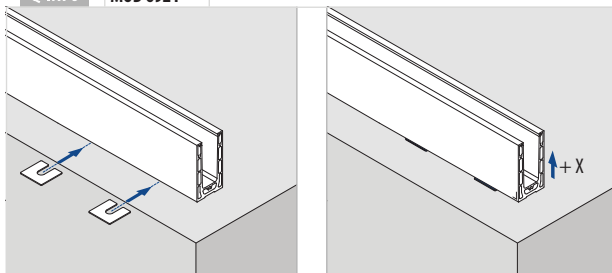

Q-INFO MOD 6948

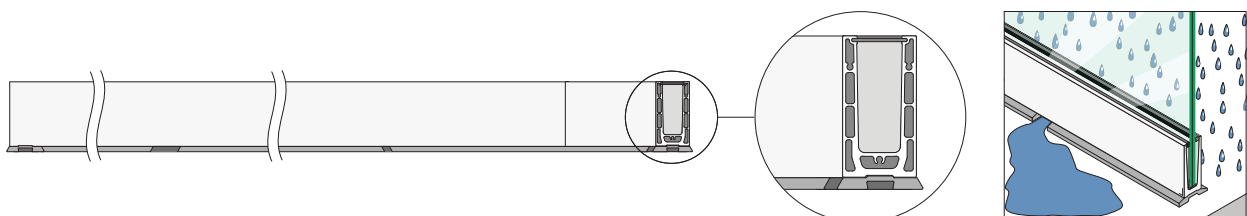

EASY GLASS® SMART - Base shoe, fascia mount

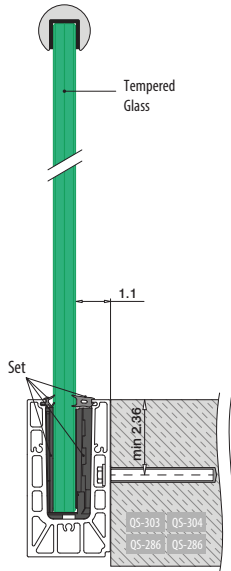

Please refer to the respective certificates for specifications such as mounting details, glass dimensions and glass type (laminated glass / monolithic glass).

Assembly information:
q-railing.com/
qr-smart

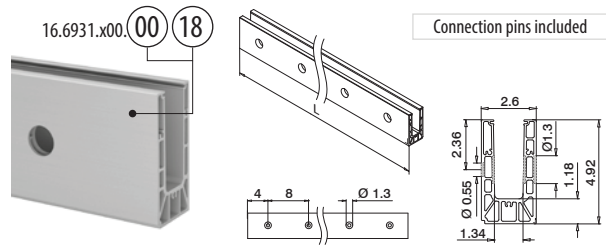

MOD 6931

Aluminum	Mill finish		
16.6931.600.00	See overview on 226	L = 20' (6096 mm)	
Aluminum	Brushed, anodized		
OUTDOOR			
16.6931.300.18	See overview on 226	L = 10' (3048 mm)	
16.6931.600.18	See overview on 226	L = 20' (6096 mm)	



EASY GLASS® SMART - Connectors, fascia mount

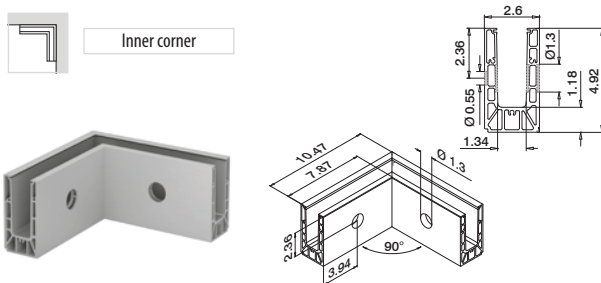

MOD 6315

Aluminum	Mill finish		
16.6315.031.00	See overview on 226	1	
Aluminum	Brushed, anodized		
OUTDOOR			
16.6315.031.18	See overview on 226	1	

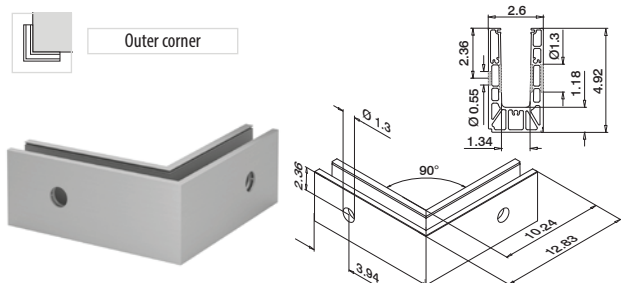

MOD 6316

Aluminum	Mill finish		
16.6316.031.00	See overview on 226	1	
Aluminum	Brushed, anodized		
OUTDOOR			
16.6316.031.18	See overview on 226	1	



Q-INFO

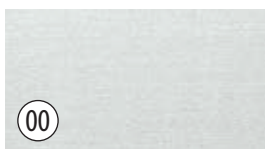

Mill finish

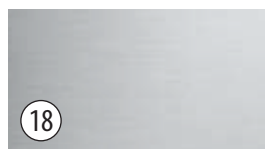

Brushed, anodized

Q-INFO

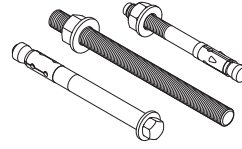

All anchors
See 226 – 233

Q-INFO

PREFIX

We can deliver the following service according to your specification:

- Cutting
- Bending
- Powder coating (aluminum mill finish products)

Contact us for details.

Railing bases

EASY GLASS® SMART -
Rubber set, inlay and Q-disc®

For adjustable
glass fixation

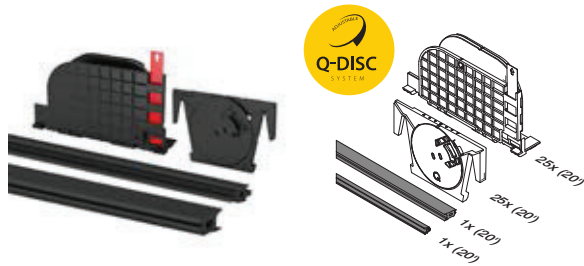

MOD 6931

Accessories		
Monolithic	T (glass thickness)	
19.6931.612.00	1/2" (12 mm)	L = 20' (6096 mm)
19.6931.615.00	19/32" (15 mm)	L = 20' (6096 mm)
Laminated		
19.6931.613.00	1/2" (12.76 mm)	L = 20' (6096 mm)
19.6931.614.00	9/16" (13.52 mm)	L = 20' (6096 mm)
19.6931.617.00	5/8" (16.76 mm)	L = 20' (6096 mm)
19.6931.618.00	11/16" (17.52 mm)	L = 20' (6096 mm)

NEW

Q-disc System: Glass is securely retained. Drilling is not necessary.

Railing bases

EASY GLASS® SMART - Cover / intermediate rubber

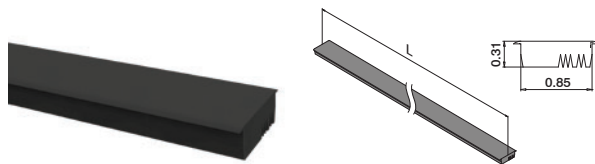

MOD 6901

Accessories	
19.6901.001.00	L = 8.2' (2500 mm)

NEW



Accessories

All dimension drawings are in inches

EASY GLASS® - Q-disc® and inlay tool



MOD 6922

Accessories		
	Q	
19.6922.000.00	Q-84	1

NEW

Railing bases

EASY GLASS® SMART - Blind plug for fascia mounting

Use without
cladding

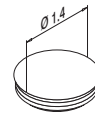

MOD 6915

Plastic	Aluminum RAL 9006
OUTDOOR	
24.6915.033.36	10

NEW

Railing bases

EASY GLASS® - Connection pin

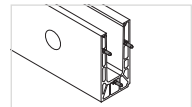
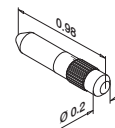

MOD 3005

316	
OUTDOOR	
14.3005.000.00	6



Q-INFO MOD 6901

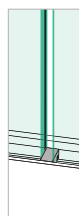
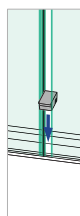
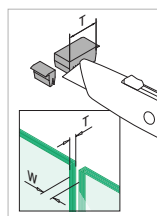
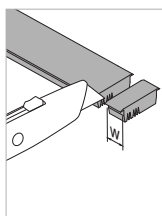

Q-INFO MOD 6922

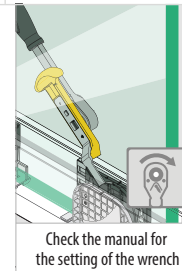
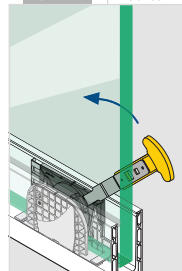

Check the manual for
the setting of the wrench

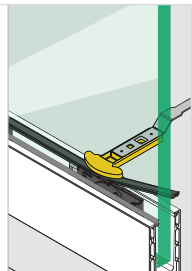

EASY GLASS® SMART - End fittings, fascia mount



Use with and without
cladding

Left

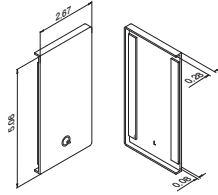
**MOD 6734**

Aluminum	Mill finish	
16.6734.031.00		1
Aluminum	Brushed, anodized	
OUTDOOR		
16.6734.031.18		1

NEW



Use with and without
cladding

Right

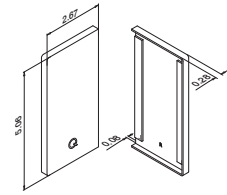
**MOD 6735**

Aluminum	Mill finish	
16.6735.031.00		1
Aluminum	Brushed, anodized	
OUTDOOR		
16.6735.031.18		1

NEW



Use with and without
cladding

For stairs

Left

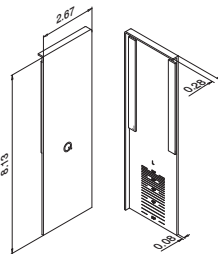
**MOD 6736**

Aluminum	Mill finish	
16.6736.031.00		1
Aluminum	Brushed, anodized	
OUTDOOR		
16.6736.031.18		1

NEW



Use with and without
cladding

For stairs

Right

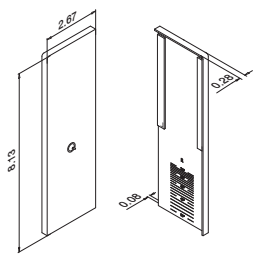
**MOD 6737**

Aluminum	Mill finish	
16.6737.031.00		1
Aluminum	Brushed, anodized	
OUTDOOR		
16.6737.031.18		1

NEW



Q-INFO MOD 6734 / 6735

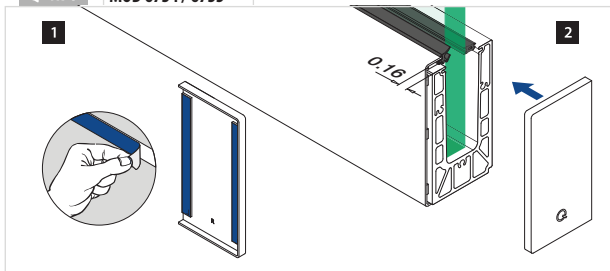

Q-INFO MOD 6736 / 6737

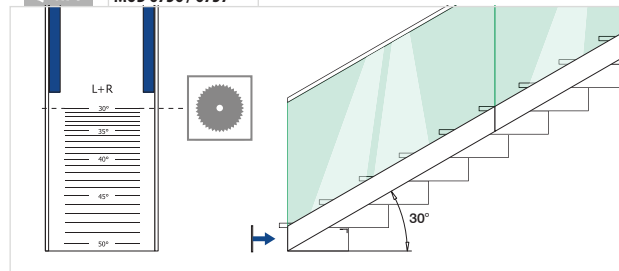

Railing bases

SATIN

EASY GLASS® SMART - Cladding, fascia mount



Front side cladding

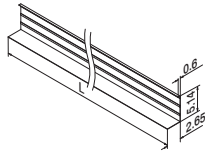

MOD 6920

Aluminum

Mill finish

16.6920.631.00

L = 20' (6096 mm)

Aluminum

Brushed, anodized

OUTDOOR

16.6920.631.18

L = 20' (6096 mm)

NEW



Railing bases

All dimension drawings are in inches

EASY GLASS® SMART - Drainage profile, fascia mount

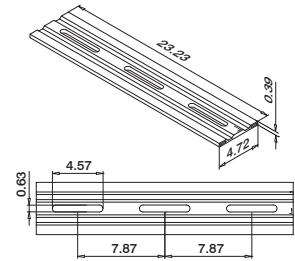

MOD 6948

Aluminum

Brushed, anodized

OUTDOOR

16.6948.031.18

4

NEW

Q-INFO

MOD 6920

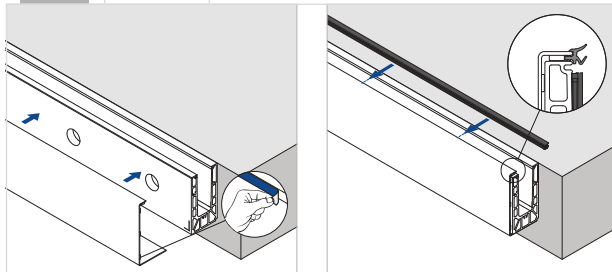

Q-INFO

MOD 6948

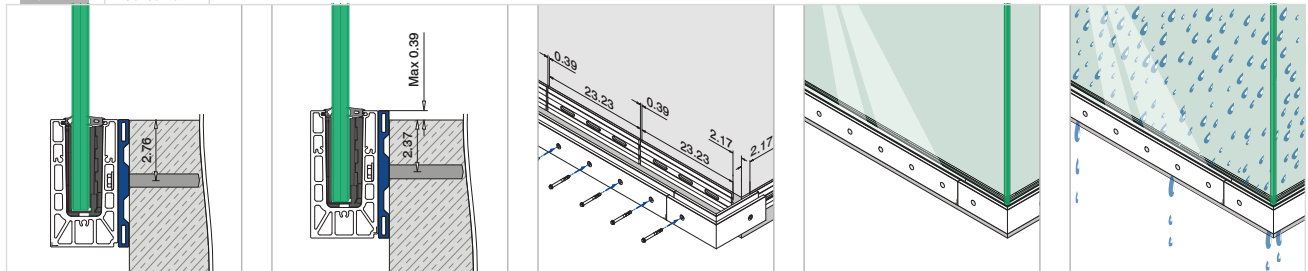



EASY GLASS SMART